

Conveyor Flow Switch

- This switch detects (monitors) the presence of a powder transported on a belt conveyor.
- As no motor is used the unit is simple and operation is stable.
- Paddle size and dimension L can be made to specified dimensions.
- Use PAF-1 for detecting flow in chutes.

For Conveyor Use



For Chute Use



PA-1

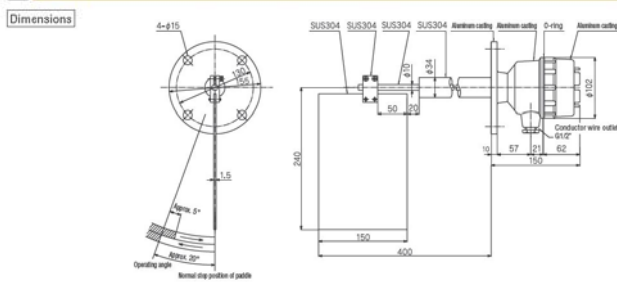

PAF-1

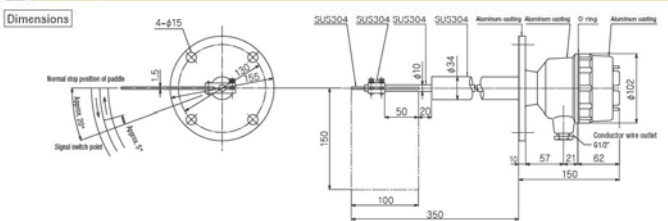

Conveyor Flow Switch

Connection	Flange attachment JIS 5K 65A	Material	Main unit case & flange Shaft & paddle Seal	Die cast aluminum SUS 304 Nitrile rubber	Paint color	PA-1, PAF-1 Munsell 10YR7.5/14
Contact output	1C contact 250 VAC 10 A (resistive load)				Protection rating	IP65
Operating angle	Approx. 20°					

*When ordering, specify whether the paddle should move clockwise or counterclockwise when viewed from end on.

Attachment examples

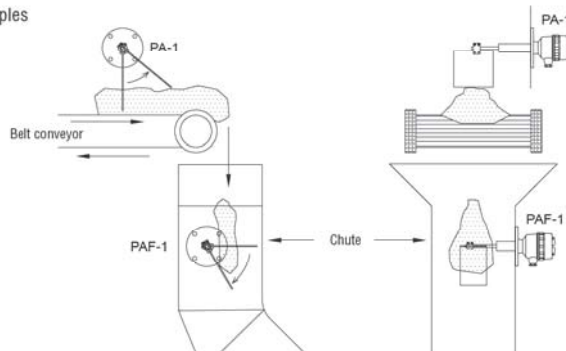

PA-1E

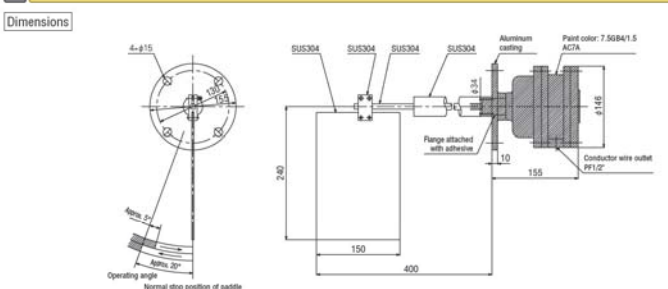

Conveyor Flow Switch

Connection	Flange attachment JIS 5K 65A	Material	Main unit case & flange Shaft & paddle Seal	Die cast aluminum SUS 304 Nitrile rubber	Paint color	Munsell 7.5BG 4/1.5
Contact output	1C contact 250 VAC 10 A (resistive load)				Protection rating	PA-1E d2G4
Operating angle	Approx. 20°					

*When ordering, specify whether the paddle should move clockwise or counterclockwise when viewed from end on.